

Floorplan

MICHAEL C.
CARLOS
MUSEUM

EMORY

Use this guide to
help you plan your event
at the Carlos Museum.

Level three

3

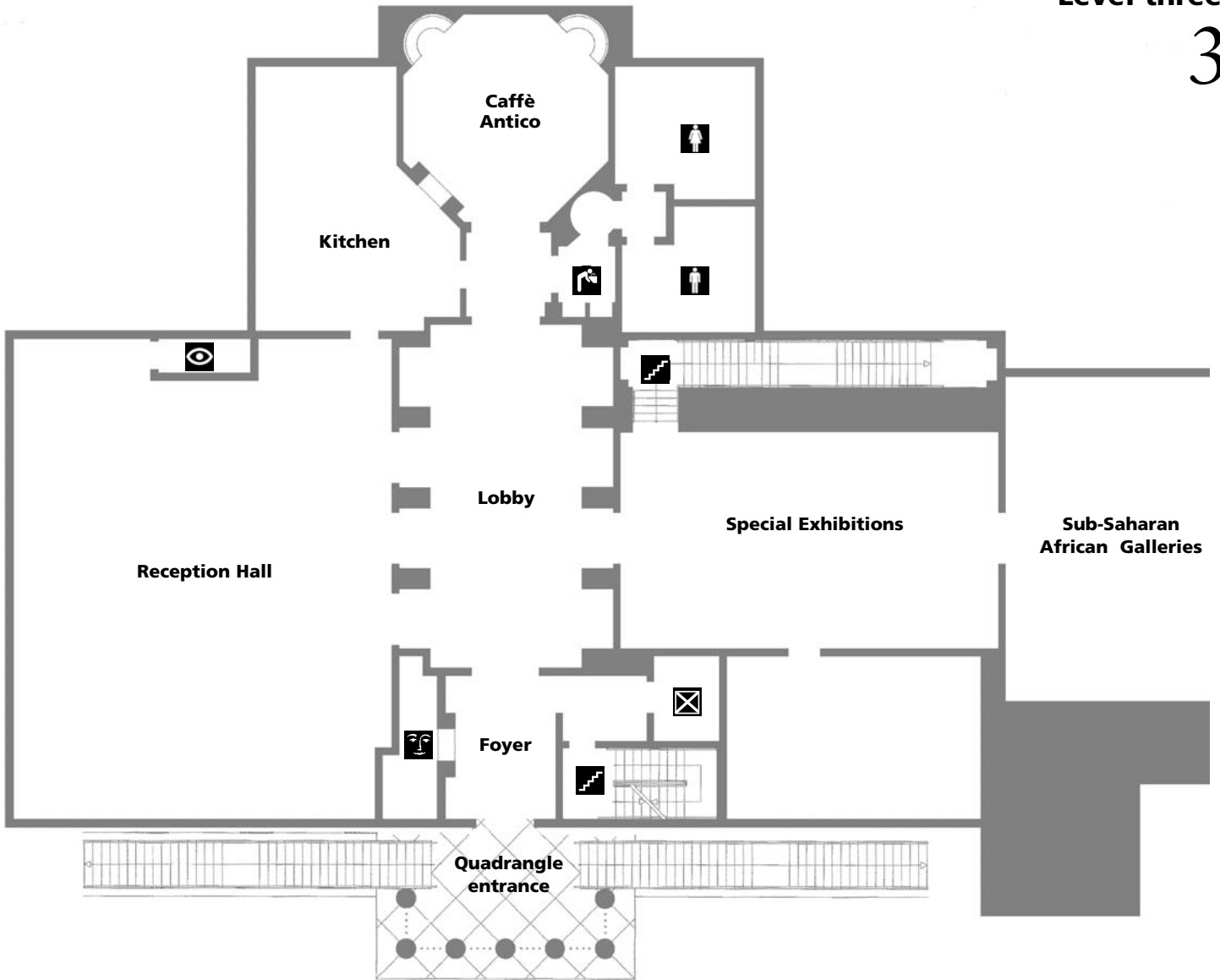

| | SQUARE FOOTAGE | GUEST CAPACITY | ROOM DIMENSIONS |
|-----------------------|----------------|------------------|-------------------|
| Reception Hall | 2,060 | 250 (120 seated) | 41'9" x 51'8" |
| Caffè Antico | 506 | 35 | 8' x 8' octagonal |
| Lobby | 1,127 | 110 | 18' x 45' |
| | 4,206 total | | |

-  Reception desk
-  Audio/visual closet
-  Elevators
-  Stairs
-  Restrooms
-  Water fountains

**Where special events
are always
a work of art.**

*Measurements are
approximate and
do not account for
certain design elements.*